

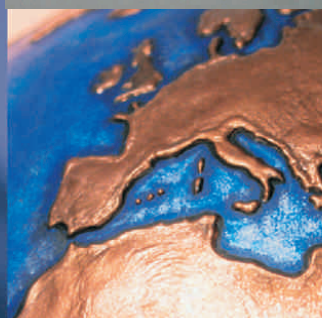

**Junior**  
GAS SPRING



# FIT ENDS CATALOGUE

## Junior Gas Spring

Gas Springs

Resortes  
Neumáticos

Verins

Molle a Gas

Gasfeder

Amortecedores  
da mala



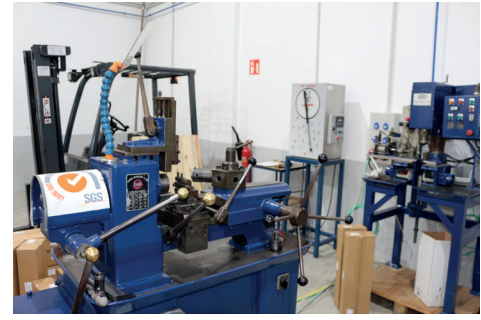

Certificate ES10/8319

The management system of

**JUNIOR DERQUI, S.L.**  
**(JUNIOR GAS SPRING)**

Complejo Ideal, Pol. Ind. Alcalá 10, C/ 2, Nave 2  
41500 Alcalá de Guadaíra (Sevilla)

has been assessed and certified as meeting the requirements of

**ISO 9001:2015**  
For the following activities

**Gas springs manufacturing and distribution for automotive and furniture uses.**

in/ from the following sites  
Complejo Ideal, Pol. Ind. Alcalá 10, C/ 2, Nave 2 - 41500 Alcalá de Guadaíra (Sevilla)

This certificate is valid from  
14 June 2019 until 14 June 2022.  
Issue 6. Certified with SGS since June 2010.

Authorized by

  
Certification Management

SGS INTERNATIONAL CERTIFICATION SERVICES IBERICA, S.A.U.  
C/Respaderne, 29, 28042 Madrid, España.  
t 34 91 313 8115 f 34 91 313 8102 www.sgs.com

Page 1 of 1











This document is issued by the Company subject to its General Conditions of Certification Services accessible at [www.sgs.com/terms\\_and\\_conditions.htm](http://www.sgs.com/terms_and_conditions.htm). Attention is drawn to the limitations of liability, indemnification and jurisdictional issues established therein. The authenticity of this document may be verified at <http://www.sgs.com/certified-clients-and-products/certified-client-directory>. Any unauthorized alteration, forgery or falsification of the content or appearance of this document is unlawful and offenders may be prosecuted to the fullest extent of the law.



Empresa colaboradora



**UN RETO SOCIAL  
EMPRESARIAL**

Una iniciativa de Cruz Roja  
para la inserción laboral

Cada vez más cerca de las personas 







## THE COMPANY

JUNIOR GAS SPRING (JUNIOR DERQUI S.L.U.) was founded in 2002 and has been consolidated throughout these 20 years of experience in the national and international market to which it supplies gas springs to OE producers for bus, furniture and industrial sector.

Currently, Junior Gas Spring has the capacity to produce 300,000 springs per year tailored to its customers and with no minimum quantity per order, thanks to a patented system by which with only 85 references they can provide service for the equivalent of a stock of 1,421 passenger cars.

The company, has been following the ISO 9001:2015 quality management system since 2009 without any non conformity, and uses management systems such as the 5's , lean manufacturing and visual management. As a result of the innovations that the company has been introducing throughout these years of evolution, today it has an average service rate of 99.5% (order fill rate) in 24 hours, (Iberian Peninsula) in its orders, agility that it achieves thanks to the qualified manufacturing team and the sales team, made up of 26 people, of which 18 are sales agents distributed in Spain, Portugal, England and France.

The weekly review of the business parameters is a work guideline that the company has followed since its inception, as it has been applying in all its processes.

The key of our successful evolution consists in having unloaded stock that is customized at the last moment. For this we use control systems where we obtain the traceability of the product both in the manufacture and in the expedition”.

Junior Gas Spring is one of the very few manufacturers in Europe dedicated mainly to automotive spare parts and has several patents for gas springs.

The company has been awarded by the CEA (Andalusian entrepreneur's organization) for its industrial excellence , also the Red Cross for its social commitment and the IIST (Instituto Internacional San Telmo Business school) .

The company follows an environmental policy using a patented system of retractable sleeves instead of painting and recycling 100% of the waste.

1. A Gas Spring is filled with oil and highly pressurized gas. Therefore, do not try to open or drill into a Gas spring.
2. JUNIOR Gas Springs should be installed with the rod end downward.
3. First, check and compare design, length and mountings before installing the new gas spring.
4. Remember that it is the gas springs that holds the bonnet and rear hatch.
5. To avoid injuries of any kind, ensure a secure fastening of the bonnet or rear hatch when replacing springs.
6. Check mounting points in the body. If they are damaged they should be changed or repaired.
7. We recommend that the springs on the vehicle should be replaced in pairs.
8. On a car that has been extra equipped with blinds or spoilers for example. There is a risk that the rear hatch may be too heavy for gas spring designed with the original elevating power.
9. Gas Springs are design to bear axial loads only. Consequently any side load forces should be avoided. Specifically when Gas Springs are equipped with eyelet end fittings, special attention should be paid to design of connecting shafts in order to provide appropriated clearance (according to each application). As an indication only, we would advise: 0.3 to 0.5 mm clearance on shafts diameter and 0.5 to 1.0 mm clearance on each side of the eyelets.
10. The rod should be protected from particle blasting.
11. Please contact us when Gas Springs have to be working in corrosive environment or outside with the rod in extended position.
12. Make sure to avoid pollution of the rod surface by glue, putty, adhesives, corrosive products, paint, etc...
13. When the cylinder has to be repainted, be careful to protect the rod (solvents should not be used to clean the rod in order to avoid damaging the seal).
14. Protect the rod from blows, shocks, sparks from electric or grinding machines.
15. Never grip the rod with pliers or in a vice without using efficient protective lead, aluminum or copper jaws.
16. Be careful to heating effect of infrared devices (80°C maximum allowed temperature).
17. Operating temperature range : from -30°C to + 80°C Endurance behavior based on 60.000 working cycles test: 15% maximum performance loss. (test actual results will vary according to stroke length and nominal force value).
18. Nominal data are given for 20°C reference temperature. For each step of 3°C, forces variation might be 1%. Check "temperature Vs F1" in "downloads"
19. The self-contained gas (Nitrogen) is a neutral component of the atmosphere. Consequently, gas release is totally safe.
20. The Gas Spring other components, except the oil, are mainly steel so recycling of these components is similar to steel recycling.
21. To avoid pollution, used oil should be collected according to specific industrial waste regulations of each country.



1.



VIDEO TUTORIAL



## JB

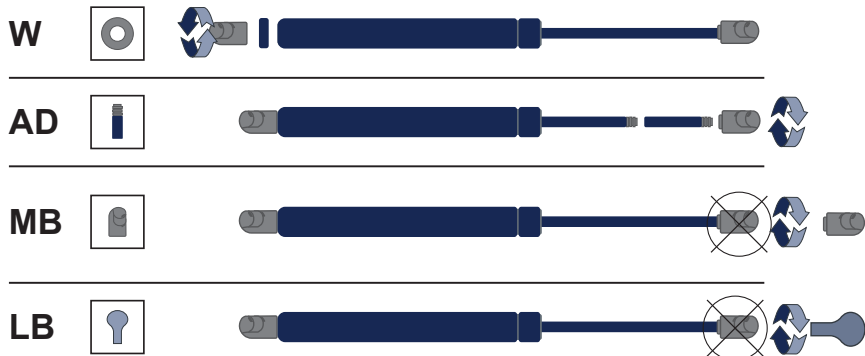

## AGS



## GI



FIXATION KITS / KITS DE FIJACIÓN. mm.

**FK025 6P JB**  
**JB SET BALL-BALL**  
 KIT JB RÓTULA-RÓTULA

**FK100 6P GE**  
**GENERIC SET EYE-EYE**  
 KIT GENERICO OJO-OJO

**FK002 5P E6**

KIT 5 PIECES / 5 PIEZAS

OREJETAS PEQUEÑAS 18MM-M6 / METAL EYELET / SMALL M6-0302

**FK003 10P W**

ARANDELAS M6 / WASHER M6

**FK300 5P AD**

PROLONGADOR M7 / ADAPTER M7

**FK004 5P SB**

KIT 5 PIECES / 5 PIEZAS

ROTULA METALICAS LARGAS m7 / SILVER BALL SOCKET LARGE M7

**FK005 5P GB**

KIT 5 PIECES / 5 PIEZAS

ROTULA METALICAS dorada mediana m7 / GOLDEN BALL SOCKET medium M7

**FK006 5P P7**

KIT 5 PIECES / 5 PIEZAS

ROTULA DE PLASTICO M7 / PLASTIC SOCKET M7

**FK007 5P A7**

KIT 5 PIECES / 5 PIEZAS

ROTULA DE PLASTICO ANGULAR M7 / ANGLE SOCKET M7



## FIXATION KITS / KITS DE FIJACIÓN. mm.

**FK008 5P GE**

KIT 5 PIECES / 5 PIEZAS

OREJETAS mediana M7 /  
METAL EYELET medium M7

**FK009 5P SE**

KIT 5 PIECES / 5 PIEZAS

OREJETA grande M7 8.1 /  
Large METAL EYELET M7 /8.1

**FK010 5P E6**

KIT 5 PIECES / 5 PIEZAS

OREJETA mediana M6 8.1 /  
medium METAL EYELET M6 /8.1

**FK011 5P A6**

KIT 5 PIECES / 5 PIEZAS

ROTULA PLASTICO M6 /  
PLASTIC SOCKET M6-(5151)

**FK012 5P A6**

KIT 5 PIECES / 5 PIEZAS

ROTULA ANGULAR M6 / ANGLE  
PLASTIC SOCKET M6-(5151AN)

**FK013 5P S6**

KIT 5 PIECES / 5 PIEZAS

ESPIGA METALICA M6-10MM /  
METAL STUD HEXAGONAL M6

**FK014 5P S8**

KIT 5 PIECES / 5 PIEZAS

ESPIGA METALICA M8 -10MM /  
METAL STUD HEXAGONAL M8

**FK015 1P BP**

1 PIECE / 1 PIEZA

TETON METALICO PARALELO /  
PARALLEL METAL BRACKET

FIXATION KITS / KITS DE FIJACIÓN. mm.

**FK016 1P BA**

1 PIECE / 1 PIEZA

ANCLAJE ANGULAR METALICO / ANGLE METAL BRACKET

**FK017 5P E6**

KIT 5 PIECES / 5 PIEZAS

OREJETA MEDIANA M6 Ø9.1 / METAL EYELET MEDIUM M6 Ø9.1

**FK018 5P BS**

KIT 5 PIECES / 5 PIEZAS

ROTULA METALICA PEQUEÑA M6 / BALL SOCKET SMALL M6

**FK019 5P BS**

KIT 5 PIECES / 5 PIEZAS

ROTULA METALICA mediana M6 / BALL SOCKET medium M6

**FK020 5P BS**

KIT 5 PIECES / 5 PIEZAS

ROTULA METALICA pequeña M7 / BALL SOCKET small M7

**FK021 5P F8**

KIT 5 PIECES / 5 PIEZAS

OREJETA METALICA PLANA M8 10MM / FLAT METAL EYELET M8 / 10

**FK022 5P R8**

KIT 5 PIECES / 5 PIEZAS

OREJETA METALICA REDONDA M8 / 8 // ROUNDED METAL EYELET M8 / 8

**FK023 5P BS**

KIT 5 PIECES / 5 PIEZAS

ROTULA METALICA grande M6 / BALL SOCKET large M6



## FIXATION KITS / KITS DE FIJACIÓN. mm.

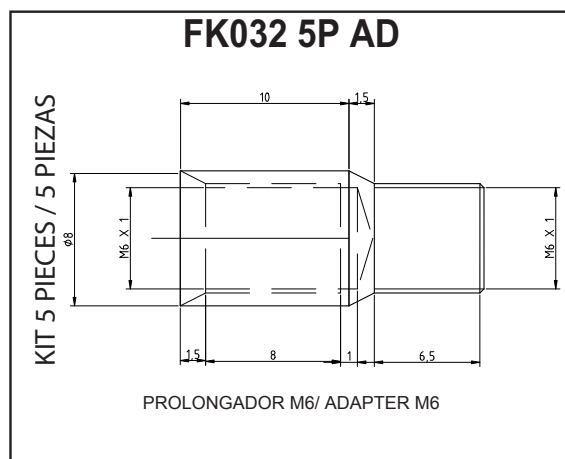
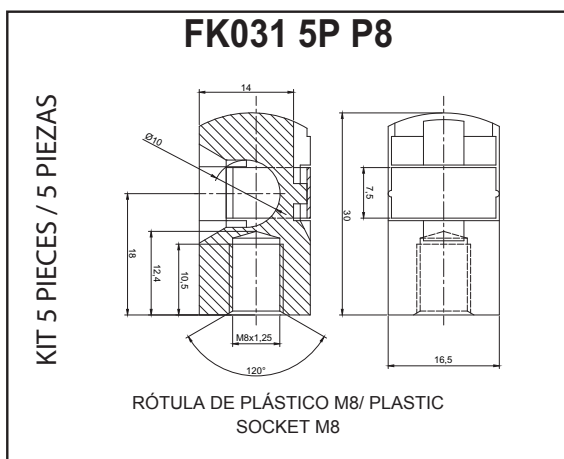
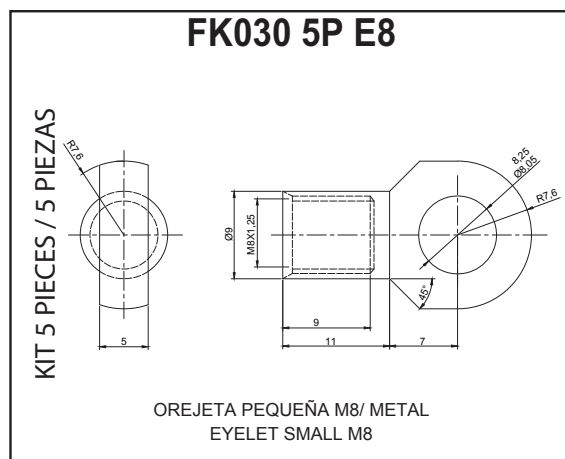
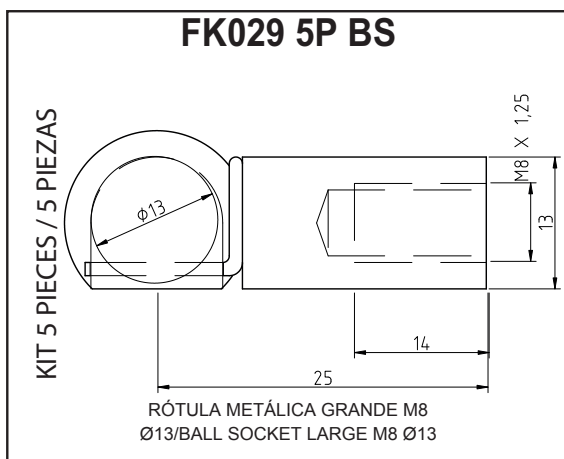
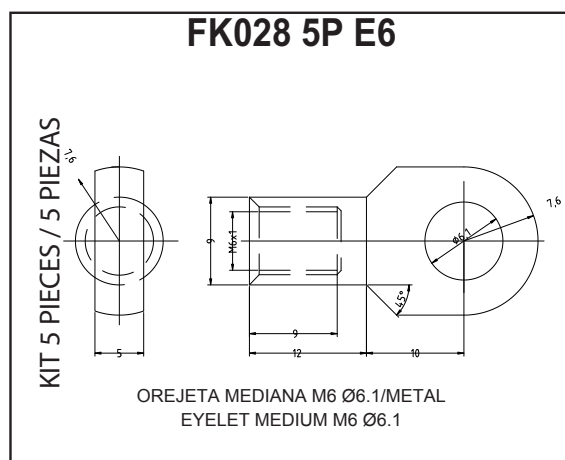
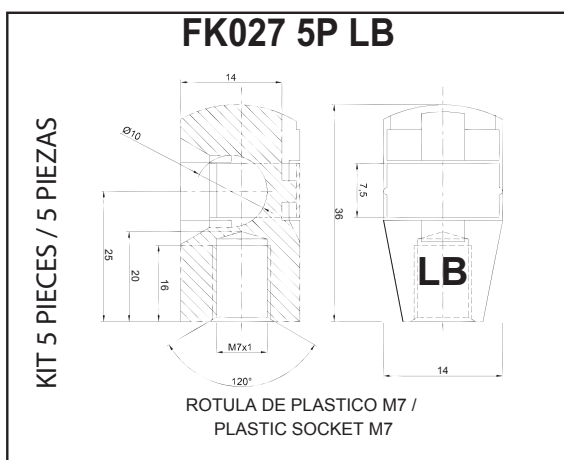
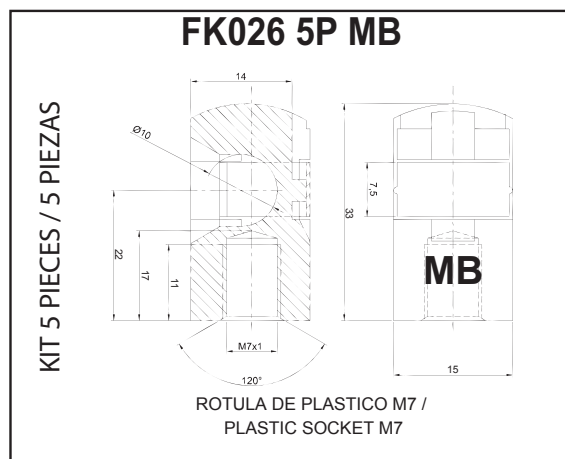
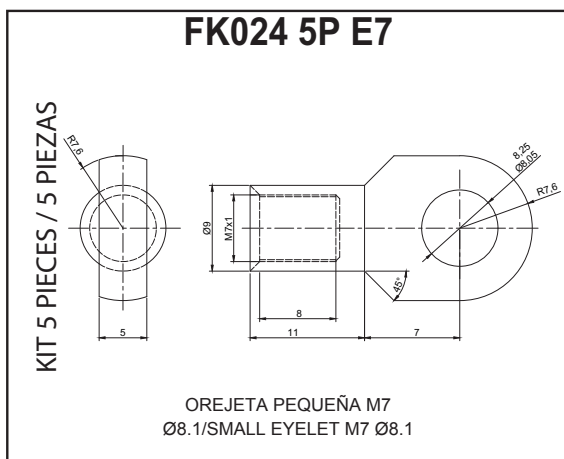

FIXATION KITS / KITS DE FIJACIÓN. mm.

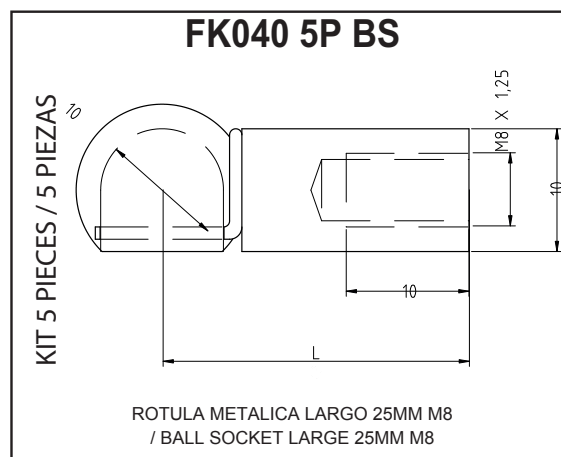
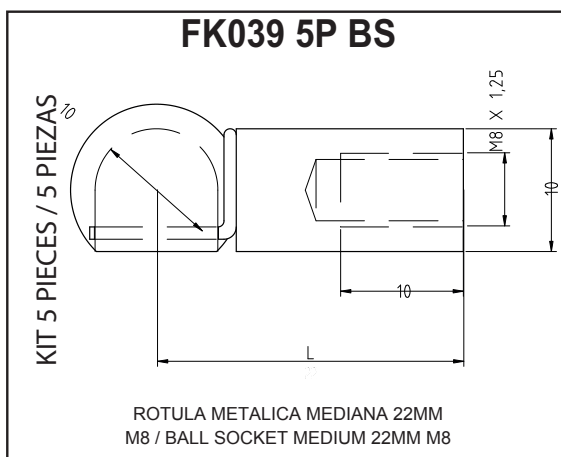
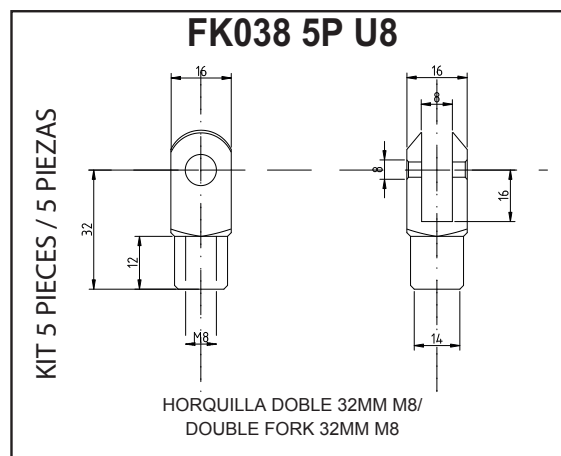
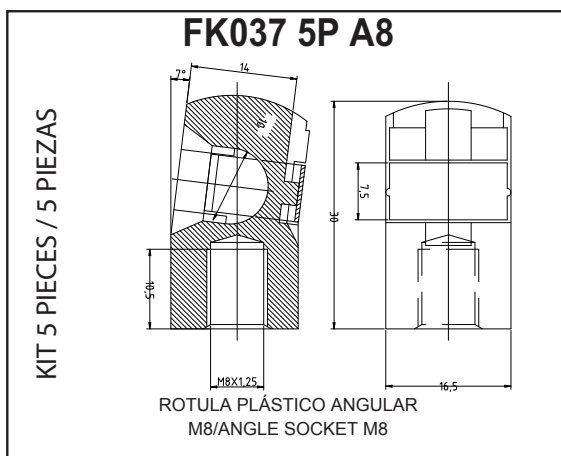
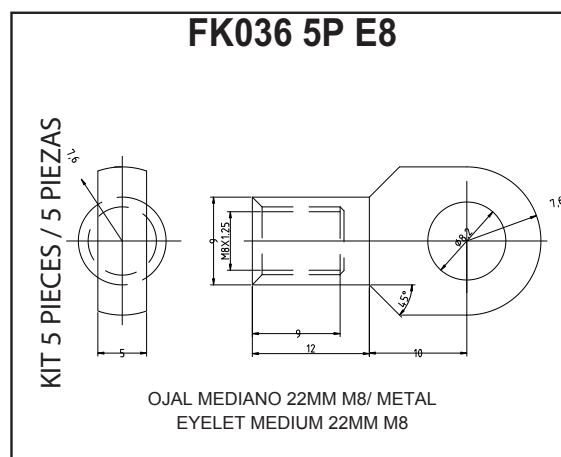
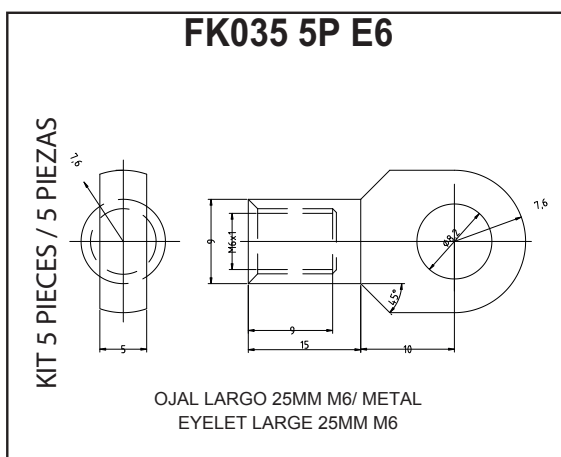
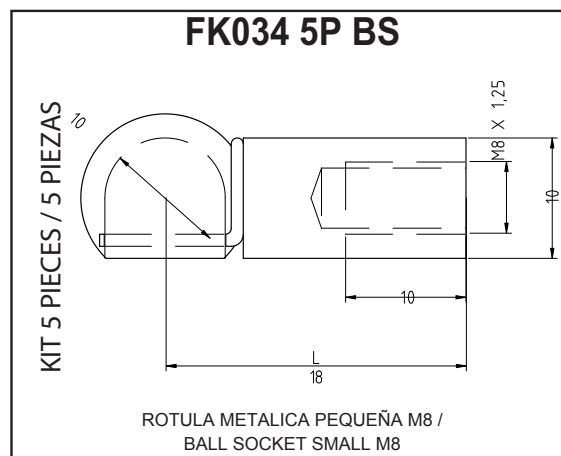
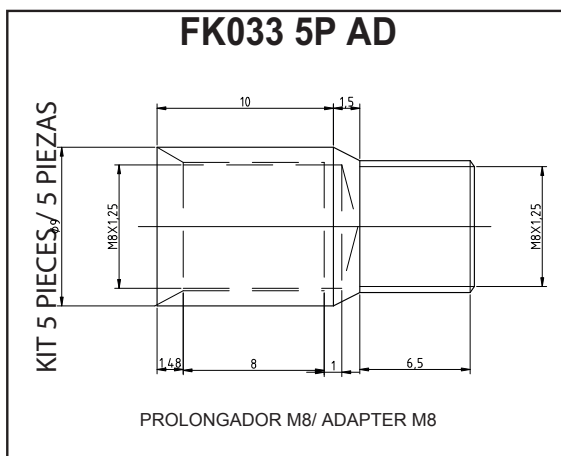



**FIXATION KITS / KITS DE FIJACIÓN. mm.**

<p align="center"><b>FK041 5P S8</b></p> <p>KIT 5 PIECES / 5 PIEZAS</p> <p align="center">ESPIGA METALICA M8 - Ø13/ METAL STUD HEXAGONAL M8 - Ø13</p>	<p align="center"><b>FK042 5P E8</b></p> <p>KIT 5 PIECES / 5 PIEZAS</p> <p align="center">OJAL LARGO 25MM M8/ METAL EYELET LARGE 25MM M8</p>
<p align="center"><b>FK043 5P E8</b></p> <p>KIT 5 PIECES / 5 PIEZAS</p> <p align="center">ESPIGA METALICA M8 - Ø10/ METAL STUD HEXAGONAL M8 - Ø10 - 20MM</p>	<p align="center"><b>FK044 5P S8</b></p> <p>KIT 5 PIECES / 5 PIEZAS</p> <p align="center">ESPIGA METALICA M8 - Ø10/ METAL STUD HEXAGONAL M8 - Ø10 - 30MM</p>
<p align="center"><b>FK045 5P E10</b></p> <p>KIT 5 PIECES / 5 PIEZAS</p> <p align="center">OREJETA GRANDE M6 Ø10.0/ METAL EYELET LARGE M6 Ø10.0</p>	<p align="center"><b>FK046 5P E10</b></p> <p>KIT 5 PIECES / 5 PIEZAS</p> <p align="center">OREJETA METÁLICA PLANA M6 Ø10/ FLAT METAL EYELET M6 Ø10</p>
<p align="center"><b>FK047 5P E6</b></p> <p>KIT 5 PIECES / 5 PIEZAS</p> <p align="center">OREJETA MEDIANA M7 Ø6,1/ METAL EYELET MEDIUM M7 Ø6,1</p>	<p align="center"><b>FK048 5P S8</b></p> <p>KIT 5 PIECES / 5 PIEZAS</p> <p align="center">ROTULA METALICA GRANDE M6 BOLA Ø13/ BALL SOCKET M6 Ø13</p>

FIXATION KITS / KITS DE FIJACIÓN. mm.

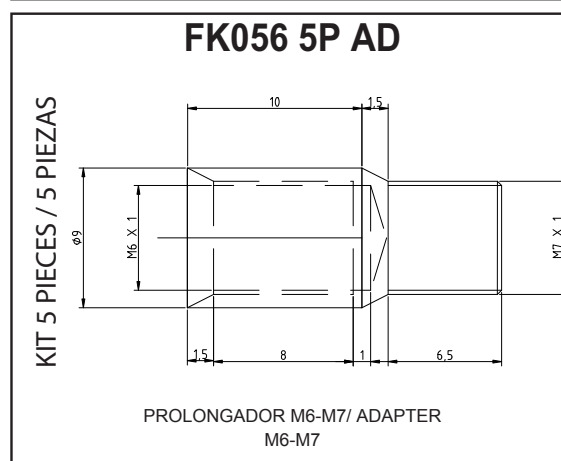
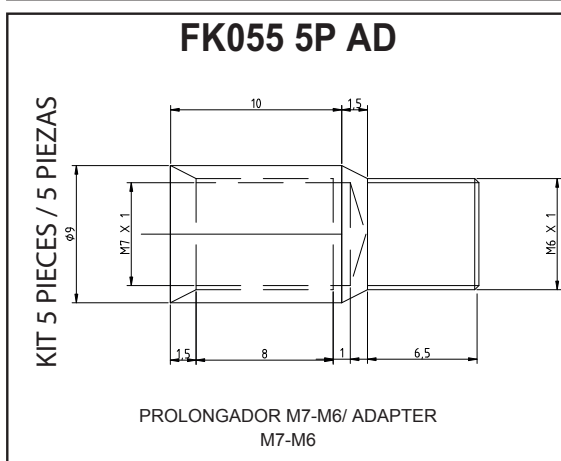
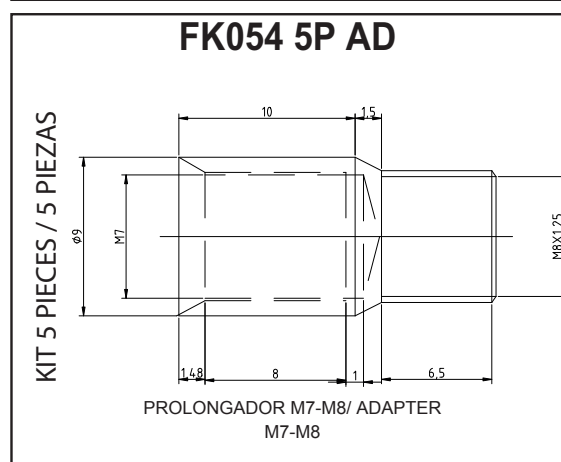
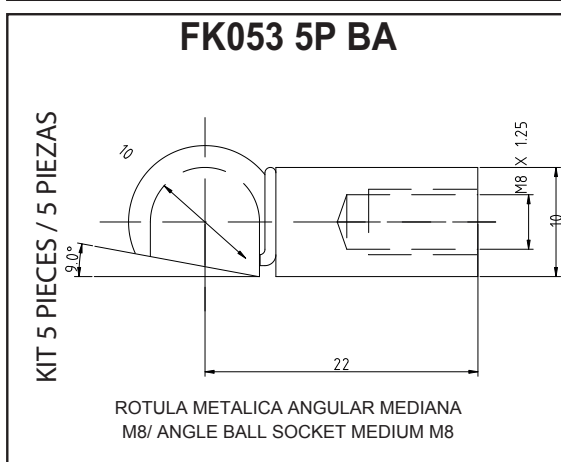
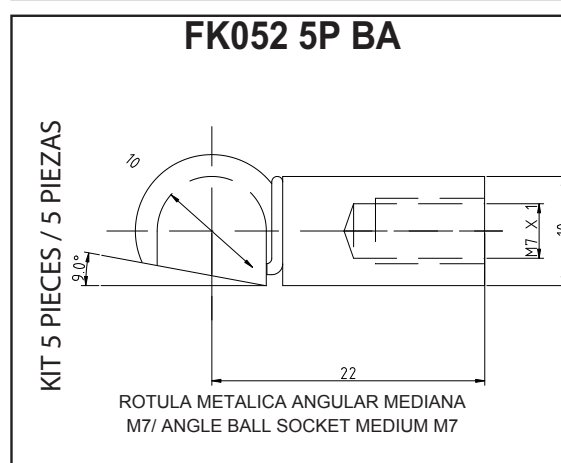
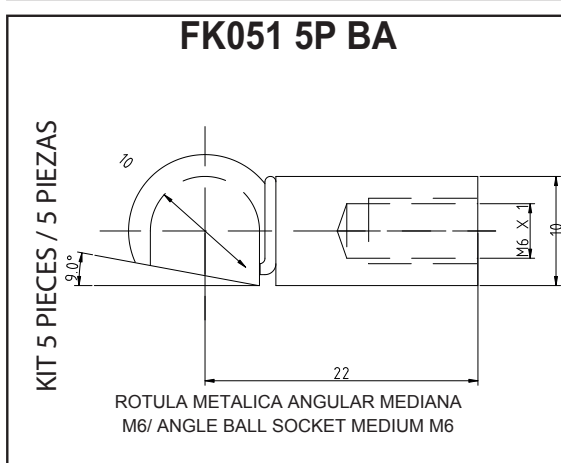
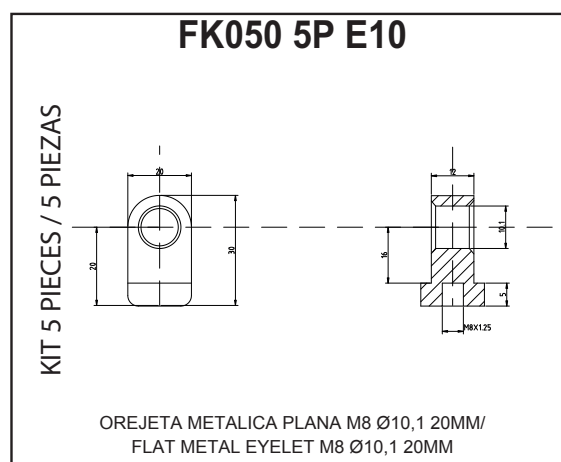
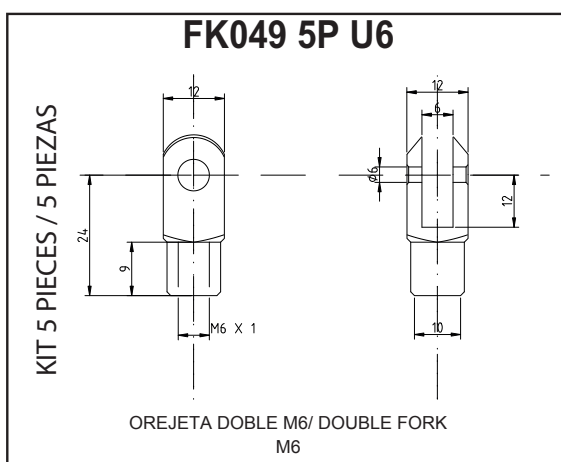

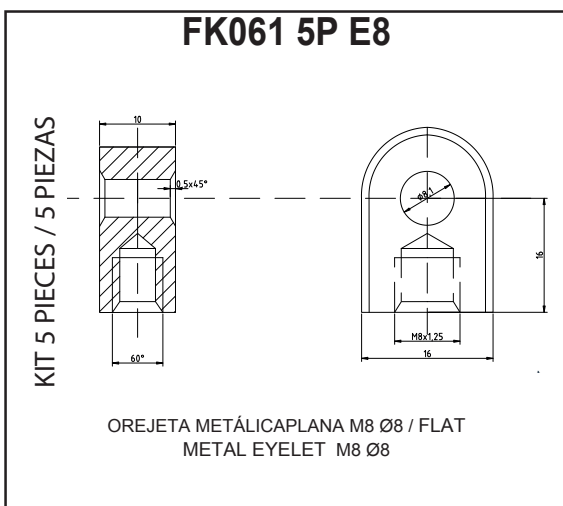
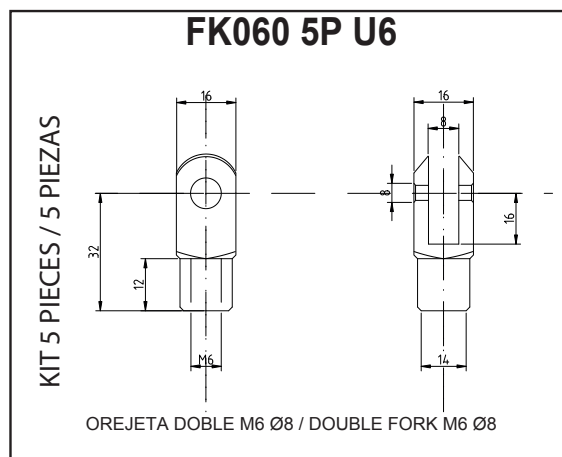
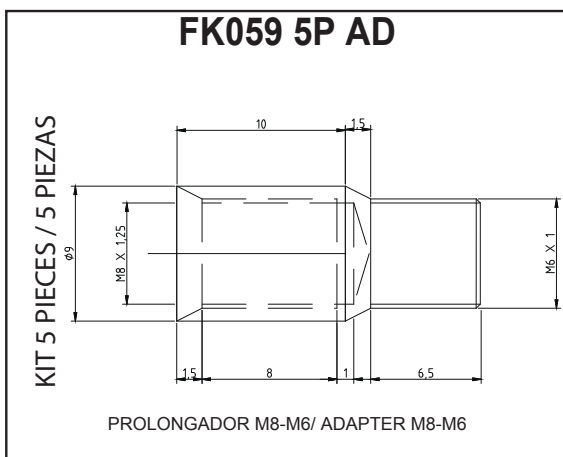
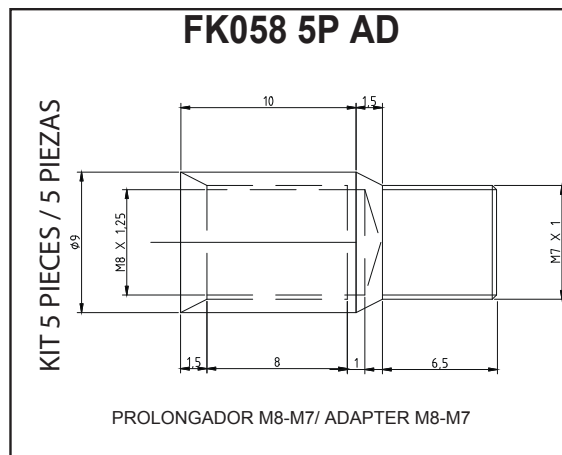
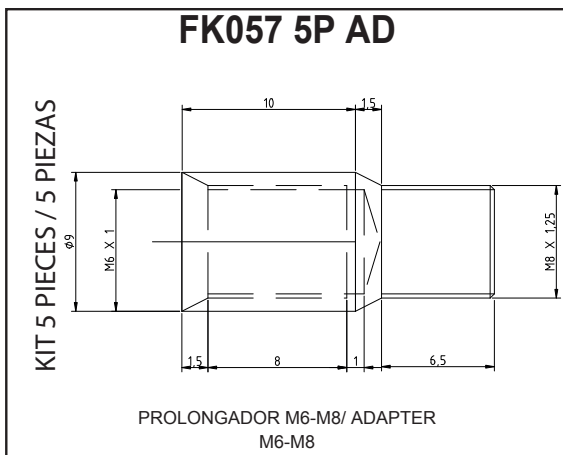
**FIXATION KITS / KITS DE FIJACIÓN. mm.**
**FIXATION KITS / KITS DE FIJACIÓN. mm.**



 C/4 N°14 P.I. ALCALÁ X, 41500  
ALCALÁ DE GUADAIRA (SEVILLA)

 +34955630127

 +34637833298

 pedidos@juniorgasspring.com





**Junior**  
GAS SPRING

*less stock, more service*

[www.juniorgs.com](http://www.juniorgs.com)

[pedidos@juniorgasspring.com](mailto:pedidos@juniorgasspring.com)

TLF: + 34 955 630 137



N37°21.920' W5°52.70'

# GAS SPRING

