



Junior
GAS SPRING



BUS CATALOGUE

Junior Gas Spring

Gas Springs

Resortes
Neumáticos

Verins

Molle a Gas

Gasfeder

Amortecedores
da mala

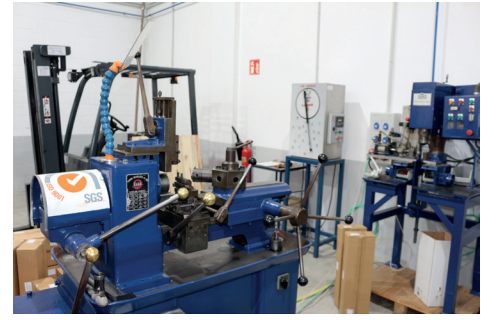

Certificate ES10/8319

The management system of

JUNIOR DERQUI, S.L.
(JUNIOR GAS SPRING)

Complejo Ideal, Pol. Ind. Alcalá 10, C/ 2, Nave 2
41500 Alcalá de Guadaíra (Sevilla)

has been assessed and certified as meeting the requirements of

ISO 9001:2015

For the following activities

Gas springs manufacturing and distribution for automotive and furniture uses.

in/ from the following sites

Complejo Ideal, Pol. Ind. Alcalá 10, C/ 2, Nave 2 - 41500 Alcalá de Guadaíra (Sevilla)

This certificate is valid from
14 June 2019 until 14 June 2022.
Issue 6. Certified with SGS since June 2010.

Authorized by

Certification Management

SGS INTERNATIONAL CERTIFICATION SERVICES IBERICA, S.A.U.
C/Respaderne, 29, 28042 Madrid, España.
t 34 91 313 8115 f 34 91 313 8102 www.sgs.com

Page 1 of 1













This document is issued by the Company subject to its General Conditions of Certification Services accessible at www.sgs.com/terms_and_conditions.htm. Attention is drawn to the limitations of liability, indemnification and jurisdictional issues established therein. The authenticity of this document may be verified at <http://www.sgs.com/certified-clients-and-products/certified-client-directory>. Any unauthorized alteration, forgery or falsification of the content or appearance of this document is unlawful and offenders may be prosecuted to the fullest extent of the law.

Empresa colaboradora



**UN RETO SOCIAL
EMPRESARIAL**

Una iniciativa de Cruz Roja
para la inserción laboral

Cada vez más cerca de las personas 



THE COMPANY

JUNIOR GAS SPRING (JUNIOR DERQUI S.L.U.) was founded in 2002 and has been consolidated throughout these 20 years of experience in the national and international market to which it supplies gas springs to OE producers for bus, furniture and industrial sector.

Currently, Junior Gas Spring has the capacity to produce 300,000 springs per year tailored to its customers and with no minimum quantity per order, thanks to a patented system by which with only 85 references they can provide service for the equivalent of a stock of 1,421 passenger cars.

The company, has been following the ISO 9001:2015 quality management system since 2009 without any non conformity, and uses management systems such as the 5's , lean manufacturing and visual management. As a result of the innovations that the company has been introducing throughout these years of evolution, today it has an average service rate of 99.5% (order fill rate) in 24 hours, (Iberian Peninsula) in its orders, agility that it achieves thanks to the qualified manufacturing team and the sales team, made up of 26 people, of which 18 are sales agents distributed in Spain, Portugal, England and France.

The weekly review of the business parameters is a work guideline that the company has followed since its inception, as it has been applying in all its processes.

The key of our successful evolution consists in having unloaded stock that is customized at the last moment. For this we use control systems where we obtain the traceability of the product both in the manufacture and in the expedition”.

Junior Gas Spring is one of the very few manufacturers in Europe dedicated mainly to automotive spare parts and has several patents for gas springs.

The company has been awarded by the CEA (Andalusian entrepreneur’s organization) for its industrial excellence , also the Red Cross for its social commitment and the IIST (Instituto Internacional San Telmo Business school) .

The company follows an environmental policy using a patented system of retractable sleeves instead of painting and recycling 100% of the waste.

1. A Gas Spring is filled with oil and highly pressurized gas. Therefore, do not try to open or drill into a Gas spring.
2. JUNIOR Gas Springs should be installed with the rod end downward.
3. First, check and compare design, length and mountings before installing the new gas spring.
4. Remember that it is the gas springs that holds the bonnet and rear hatch.
5. To avoid injuries of any kind, ensure a secure fastening of the bonnet or rear hatch when replacing springs.
6. Check mounting points in the body. If they are damaged they should be changed or repaired.
7. We recommend that the springs on the vehicle should be replaced in pairs.
8. On a car that has been extra equipped with blinds or spoilers for example. There is a risk that the rear hatch may be too heavy for gas spring designed with the original elevating power.
9. Gas Springs are design to bear axial loads only. Consequently any side load forces should be avoided. Specifically when Gas Springs are equipped with eyelet end fittings, special attention should be paid to design of connecting shafts in order to provide appropriated clearance (according to each application). As an indication only, we would advise: 0.3 to 0.5 mm clearance on shafts diameter and 0.5 to 1.0 mm clearance on each side of the eyelets.
10. The rod should be protected from particle blasting.
11. Please contact us when Gas Springs have to be working in corrosive environment or outside with the rod in extended position.
12. Make sure to avoid pollution of the rod surface by glue, putty, adhesives, corrosive products, paint, etc...
13. When the cylinder has to be repainted, be careful to protect the rod (solvents should not be used to clean the rod in order to avoid damaging the seal).
14. Protect the rod from blows, shocks, sparks from electric or grinding machines.
15. Never grip the rod with pliers or in a vice without using efficient protective lead, aluminum or copper jaws.
16. Be careful to heating effect of infrared devices (80°C maximum allowed temperature).
17. Operating temperature range : from -30°C to + 80°C Endurance behavior based on 60.000 working cycles test: 15% maximum performance loss. (test actual results will vary according to stroke length and nominal force value).
18. Nominal data are given for 20°C reference temperature. For each step of 3°C, forces variation might be 1%. Check "temperature Vs F1" in "downloads"
19. The self-contained gas (Nitrogen) is a neutral component of the atmosphere. Consequently, gas release is totally safe.
20. The Gas Spring other components, except the oil, are mainly steel so recycling of these components is similar to steel recycling.
21. To avoid pollution, used oil should be collected according to specific industrial waste regulations of each country.

1.



VIDEO TUTORIAL



JB

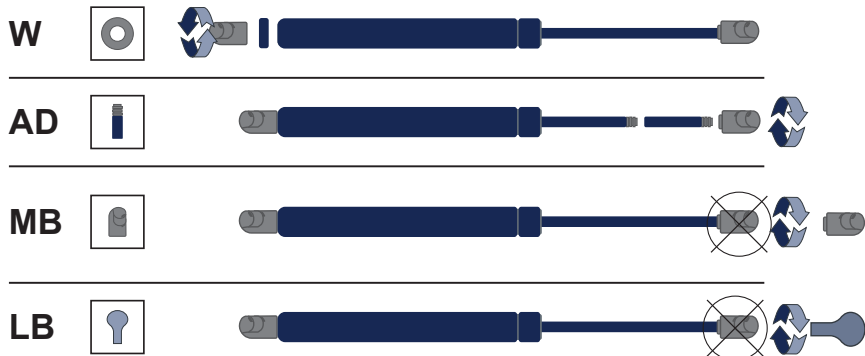

AGS



GI



BUS CATALOGUE



BRAND/ MODEL	YEAR	O.E. NUMBER	L	F1	S	W	MB	LB	AD	GENERIC		SPECIFIC	POWERLIFT
										JB	AGS		
MAN													
LION S CITY A	96-	81970060032	315	120	120							GH0123154	
LION S COACH	00-	81970060032	315	120	120							GH0123154	
LION S REGIO	15-	81970060032	315	120	120							GH0123154	PWL0284
LION S STAR RH	00-	81970060032	315	120	120							GH0123154	
FOCL	07-	81970060032	315	120	120							GH0123154	
HOCL	92-	81970060032	315	120	120							GH0123154	
NG	98-	81970060032	315	120	120							GH0123154	
NL	92-	81970060032	315	120	120							GH0123154	
NM	02-14	81970060032	315	120	120							GH0123154	
NÜ	96-	81970060032	315	120	120							GH0123154	
SL II	05-14	81970060032	315	120	120							GH0123154	
SÜ	03-	81970060032	315	120	120							GH0123154	
EL	93-01	81748210039	424	350	150							GH0354244	
LION S CITY A	96-	81748210039	424	350	150							GH0354244	
NG	92-	81748210039	424	350	150							GH0354244	
NL	89-	81748210039	424	350	150							GH0354244	
NM	92-97	81748210039	424	350	150							GH0354244	
NÜ	96-	81748210039	424	350	150							GH0354244	
SG	94-97	81748210039	424	350	150							GH0354244	
SL II	80-87	81748210039	424	350	150							GH0354244	
SL II	84-94	81748210039	424	350	150							GH0354244	
SR	75-86	81748210039	424	350	150							GH0354244	
SÜ	75-97	81748210039	424	350	150							GH0354244	
LION S CITY A	96-	81748210104	315	250	120							GH0253154	
NL	92-	81748210104	315	250	120							GH0253154	
LION S CITY A	96-	81748210110	275	50	100							GH0052754	
NG	98-	81748210110	275	50	100							GH0052754	
NL	92-	81748210110	275	50	100							GH0052754	
NÜ	96-	81748210110	275	50	100							GH0052754	
FOCL	07-	81748210148	315	120	120							GH0123154	
HOCL	92-	81748210148	315	120	120							GH0123154	

BRAND/ MODEL	YEAR	O.E. NUMBER	L	F1	S	W	MB	LB	AD	GENERIC	SPECIFIC	POWERLIFT
LION S CITY A	96-	81748210148	315	120	120						GH0123154	
LION S COACH	00-	81748210148	315	120	120						GH0123154	
LION S REGIO	15-	81748210148	315	120	120						GH0123154	PWL0286
LION S STAR RH	00-	81748210148	315	120	120						GH0123154	
NG	98-	81748210148	315	120	120						GH0123154	
NL	92-	81748210148	315	120	120						GH0123154	
NM	02-14	81748210148	315	120	120						GH0123154	
NÜ	96-	81748210148	315	120	120						GH0123154	
SL II	05-14	81748210148	315	120	120						GH0123154	
SÜ	03-	81748210148	315	120	120						GH0123154	
FOCL	07-	81970060001	315	120	120						GH0123154	
HOCL	92-	81970060001	315	120	120						GH0123154	
LION S CITY A	96-	81970060001	315	120	120						GH0123154	
LION S COACH	00-	81970060001	315	120	120						GH0123154	
LION S REGIO	15-	81970060001	315	120	120						GH0123154	PWL0287
LION S STAR RH	00-	81970060001	315	120	120						GH0123154	
NG	98-	81970060001	315	120	120						GH0123154	
NL	92-	81970060001	315	120	120						GH0123154	
NM	02-14	81970060001	315	120	120						GH0123154	
NÜ	96-	81970060001	315	120	120						GH0123154	
SL II	05-14	81970060001	315	120	120						GH0123154	
SÜ	03-	81970060001	315	120	120						GH0123154	
FOCL	07-	81970060032	315	120	120						GH0123154	
HOCL	92-	81970060032	315	120	120						GH0123154	
LION S CITY A	96-	81970060032	315	120	120						GH0123154	
LION S COACH	00-	81970060032	315	120	120						GH0123154	
LION S REGIO	15-	81970060032	315	120	120						GH0123154	PWL0288
LION S STAR RH	00-	81970060032	315	120	120						GH0123154	
NG	98-	81970060032	315	120	120						GH0123154	
NL	92-	81970060032	315	120	120						GH0123154	
NM	02-14	81970060032	315	120	120						GH0123154	
NÜ	96-	81970060032	315	120	120						GH0123154	
SL II	05-14	81970060032	315	120	120						GH0123154	
SÜ	03-	81970060032	315	120	120						GH0123154	
LION S CITY A	96-	81970060001	315	120	120						GH0123154	
LION S COACH	00-	81970060001	315	120	120						GH0123154	
LION S REGIO	15-	81970060001	315	120	120						GH0123154	PWL0289
LION S STAR RH	00-	81970060001	315	120	120						GH0123154	
FOCL	07-	81970060001	315	120	120						GH0123154	
HOCL	92-	81970060001	315	120	120						GH0123154	
NG	98-	81970060001	315	120	120						GH0123154	
NL	92-	81970060001	315	120	120						GH0123154	
NM	02-14	81970060001	315	120	120						GH0123154	
NÜ	96-	81970060001	315	120	120						GH0123154	
SL II	05-14	81970060001	315	120	120						GH0123154	
SÜ	03-	81970060001	315	120	120						GH0123154	
LION S CITY A	96-	81748210148	315	120	120						GH0123154	
LION S COACH	00-	81748210148	315	120	120						GH0123154	
LION S REGIO	15-	81748210148	315	120	120						GH0123154	PWL0290
LION S STAR RH	00-	81748210148	315	120	120						GH0123154	
FOCL	07-	81748210148	315	120	120						GH0123154	
HOCL	92-	81748210148	315	120	120						GH0123154	
NG	98-	81748210148	315	120	120						GH0123154	
NL	92-	81748210148	315	120	120						GH0123154	

BRAND/ MODEL	YEAR	O.E. NUMBER	L	F1	S	W	MB	LB	AD	GENERIC		SPECIFIC	POWERLIFT
NM	02-14	81748210148	315	120	120							GH0123154	
NÜ	96-	81748210148	315	120	120							GH0123154	
SL II	05-14	81748210148	315	120	120							GH0123154	
SÜ	03-	81748210148	315	120	120							GH0123154	
MERCEDES													
O 303	80-92	000 9807064	537	440	200							GH0445374	
O 402	86-91	000 9807064	537	440	200							GH0445374	
O 405	84-91	000 9807064	537	440	200							GH0445374	
O 303	80-92	000 9807064	537	440	200							GH0445374	
O 402	86-91	000 9807064	537	440	200							GH0445374	
O 405	84-91	000 9807064	537	440	200							GH0445374	
O 303	80-92	000 9801064	537	440	200							GH0445374	
O 303	80-92	000 7503080	537	330	200	2	-	-		JB525350	AGS550350	GH0335374	
O 303	80-92	000 7503080	537	330	200	2	-	-		JB525350	AGS550350	GH0335374	
O 405	91-	000 7503080	537	330	200	2	-	-		JB525350	AGS550350	GH0335374	
O 303	80-92	000 9804864	537	330	200	2	-	-		JB525350	AGS550350	GH0335374	
O 402	86-91	000 9801064	537	440	200							GH0445374	
CITARO	00-	A0007502980	535	220								GH0225354	
O 402	86-91	A0007502980	535	220								GH0225354	
O 405	91-	A0007502980	535	220								GH0225354	
CITARO	00-	000 7502980	535	220								GH0225354	
O 402	86-91	000 7502980	535	220								GH0225354	
O 405	84-91	000 9801064	537	440	200							GH0445374	
O 303	80-92	000 9804864	537	330	200	2	-	-		JB525350	AGS550350	GH0335374	
O 405	91-	000 7502980	535	220								GH0225354	
O 405	84-91	A0007502980	535	220								GH0225354	
O 405	86-91	A0009806964	540	490	219							GH0495404	
O 301	86-87	A0009806964	540	490	219							GH0495404	
O 303	74-92	A0009806964	540	490	219							GH0495404	
O 402	86-91	A0009806964	540	490	219							GH0495404	
O 407	87-01	A0009806964	540	490	219							GH0495404	
O 408	91-98	A0009806964	540	490	219							GH0495404	
VARIO	96-	A0009806964	540	490	219							GH0495404	
O 405	86-91	000 9806964	540	490	219							GH0495404	
O 301	86-87	000 9806964	540	490	219							GH0495404	
O 303	74-92	000 9806964	540	490	219							GH0495404	
O 402	86-91	000 9806964	540	490	219							GH0495404	
O 407	87-01	000 9806964	540	490	219							GH0495404	
O 408	91-98	000 9806964	540	490	219							GH0495404	
VARIO	96-	000 9806964	540	490	219							GH0495404	
O 405	86-91	A0009804964	540	490	219							GH0495404	
O 301	86-87	A0009804964	540	490	219							GH0495404	
O 303	74-92	A0009804964	540	490	219							GH0495404	
O 402	86-91	A0009804964	540	490	219							GH0495404	
O 407	87-01	A0009804964	540	490	219							GH0495404	
O 408	91-98	A0009804964	540	490	219							GH0495404	
VARIO	96-	A0009804964	540	490	219							GH0495404	
O 405	86-91	000 9804964	540	490	219							GH0495404	
O 301	86-87	000 9804964	540	490	219							GH0495404	
O 303	74-92	000 9804964	540	490	219							GH0495404	
O 402	86-91	000 9804964	540	490	219							GH0495404	
O 407	87-01	000 9804964	540	490	219							GH0495404	
O 408	91-98	000 9804964	540	490	219							GH0495404	
VARIO	96-	000 9804964	540	490	219							GH0495404	

BRAND/ MODEL	YEAR	O.E. NUMBER	L	F1	S	W	MB	LB	AD	GENERIC		SPECIFIC	POWERLIFT
O 405	91-	000 9804864	537	330	200	2	-	-		JB525350	AGS550350	GH0335374	
O 301	86-87	A0007503180	540	490	219							GH0495404	
O 303	80-92	A0007503180	540	490	219							GH0495404	
O 405	91-	A0007503180	540	490	219							GH0495404	
O 301	86-87	A0007503180	540	490	219							GH0495404	
O 303	74-92	A0007503180	540	490	219							GH0495404	
O 402	86-91	A0007503180	540	490	219							GH0495404	
O 407	87-01	A0007503180	540	490	219							GH0495404	
O 408	91-98	A0007503180	540	490	219							GH0495404	
VARIO	96-	A0007503180	540	490	219							GH0495404	
O 301	86-87	000 7503180	540	490	219							GH0495404	
O 303	80-92	000 7503180	540	490	219							GH0495404	
O 405	91-	000 7503180	540	490	219							GH0495404	
TRAVEGO	03-	A0007500336	582	150	204							GH0155824	
TRAVEGO	03-	A0007500336	582	150	204							GH0155824	
TRAVEGO	03-	000 7500336	582	150	204							GH0155824	
TRAVEGO	03-	000 7500336	582	150	204							GH0155824	
INTOURO	05-	6297500936	580	520	235							GH0525803	
INTEGRO	06-	A6297500936	580	520	235							GH0525803	
INTEGRO	06-	A0029801564	685	500	295							GJ0506854	
TRAVEGO	99-	A0029801564	685	500	295							GJ0506854	
INTOURO	05-	A0029801564	685	500	295							GJ0506854	
TOURISMO	03-	A0029801564	685	500	295							GJ0506854	
INTEGRO	06-	00 29801564	685	500	295							GJ0506854	
TRAVEGO	99-	6297501236	585	800	200							GJ0805854	
TRAVEGO	99-	A6297501236	585	800	200							GJ0805854	
TRAVEGO	99-	A6297500236	750	320	290							GJ0327503	
TOURISMO	03-	A6297500336	750	420	290							GJ0427503	
TRAVEGO	99-	A6297500536	750	520	290							GJ0527503	
TRAVEGO	99-	A6297500736	585	700	250							GH0705854	
TRAVEGO	99-	00 29801564	685	500	295							GJ0506854	
INTOURO	05-	A6297500936	580	520	235							GH0525803	
INTOURO	05-	00 29801564	685	500	295							GJ0506854	
TOURISMO	03-	6297501236	585	800	200							GJ0805854	
TOURISMO	03-	A6297501236	585	800	200							GJ0805854	
TOURISMO	03-	A6297500236	750	320	290							GJ0327503	
TRAVEGO	99-	A6297500336	750	420	290							GJ0427503	
TOURISMO	03-	A6297500536	750	520	290							GJ0527503	
TOURISMO	03-	A6297500736	585	700	250							GH0705854	
TOURISMO	03-	00 29801564	685	500	295							GJ0506854	
TRAVEGO	99-	A6297500936	580	520	235							GH0525803	
O 301	86-87	000 7503180	540	490	219							GH0495404	
O 303	74-92	000 7503180	540	490	219							GH0495404	
O 402	86-91	000 7503180	540	490	219							GH0495404	
O 407	87-01	000 7503180	540	490	219							GH0495404	
O 408	91-98	000 7503180	540	490	219							GH0495404	
VARIO	96-	000 7503180	540	490	219							GH0495404	
TRAVEGO (O 580)	99-	6297500836	265	100	75							GH0102651	
TRAVEGO (O 580)	99-	000 7500636	265	100	75							GH0102651	
TRAVEGO (O 580)	99-	A6297501636	350	100	100							GH0103501	

BRAND/ MODEL	YEAR	O.E. NUMBER	L	F1	S	W	MB	LB	AD	GENERIC	SPECIFIC	POWERLIFT
TOURISMO (0350)	03-	A6297501636	350	100	100						GH0103501	
RENAULT TRUCKS												
R 312	80-96	5010093384	690	450	300						GJ0466901	
SCANIA												
TOURING HD 121	14-	1346570	315	400	120						GH0403154	PWL0291
TOURING HD 121	14-	1481373	685	250	300						GH0406854	PWL0292
SETRA												
SERIES 400 TOP CLASS	02-	6297500436	750	220	290						GJ0227503	
SERIES 400 TOP CLASS	02-	A6297500436	750	220	290						GJ0227503	
SERIES 400 TOPCLASS	03-	6297501636	350	100	100						GH0103501	
SERIES 400 TOPCLASS	03-	A6297501636	350	100	100						GH0103501	
SERIES 400 TOPCLASS	03-	A6297501636	350	100	100						GH0103501	

**TECHNICAL DRAWING
BALL SOCKET**

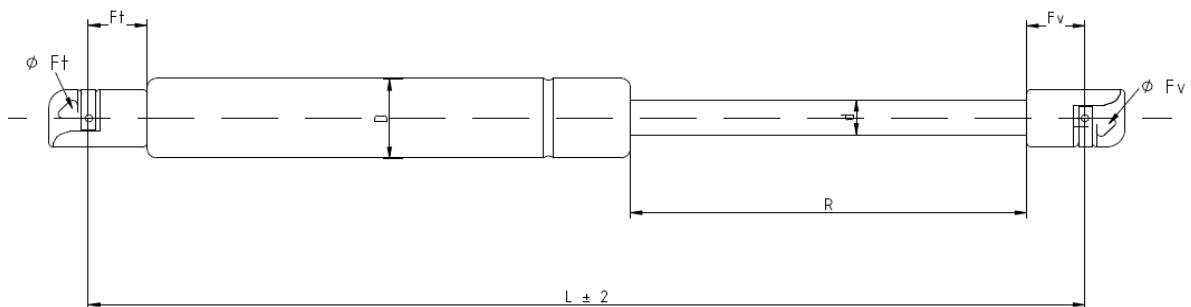



L	Length Extended	Longitud extendida entre centros	mm
R	Stroke	Recorrido	mm
F1	Force	Fuerza del resorte	Newtons
D	Tube Diameter	Diámetro Tubo	mm
d	Rod Diameter	Diámetro Vástago	mm
Ft	Tube Fit End	Fijación Tubo	mm
Fv	Rod Fit End	Fijación Vástago	mm
ϕFt	Tube Fit End Ball Diameter	Diámetro Fijación Bola Tubo	mm
ϕFv	Rod Fit End Ball Diameter	Diámetro Fijación Bola Vástago	mm
Mt	Tube Fit End Metric	Métrica de fijación al tubo	mm
Mv	Rod Fit End Metric	Métrica de fijación al vástago	mm
	QUANTITY	Cantidad	

Client's Signature



 C/4 N°14 P.I. ALCALÁ X, 41500
ALCALÁ DE GUADAIRA (SEVILLA)

 +34955630127

 +34637833298

 pedidos@juniorgasspring.com



Junior
GAS SPRING

less stock, more service

www.juniorgs.com

pedidos@juniorgasspring.com

TLF: + 34 955 630 137



N37°21.920' W5°52.70'

GAS SPRING

